



6014 NR Deep groove ball bearings

- SKF Explorer

Deep groove ball bearings

Bearing data

[Tolerances](#),

Normal (metric), P6, P5, Normal (inch),

[Radial internal clearance](#),

Matched bearing pairs, Stainless steel
 $d < 10$ mm, Other bearings

Bearing interfaces

[Seat tolerances for standard conditions](#),

[Tolerances and resultant fits](#)

Technical specification

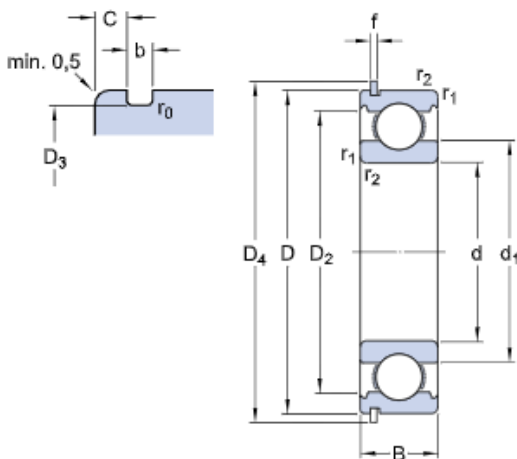

DIMENSIONS

d	70 mm	Bore diameter
D	110 mm	Outside diameter
B	20 mm	Width
d_1	≈ 82.85 mm	Shoulder diameter
D_2	≈ 99.9 mm	Recess diameter
D_3	106.81 mm	Diameter of snap ring groove
D_4	116.6 mm	Outside diameter of snap ring
b	2.7 mm	Width of snap ring groove
C	2.87 mm	Distance outer ring from side face to snap ring groove
f	2.46 mm	Width of snap ring
r_0	max. 0.6 mm	Bottom radius of snap ring groove
$r_{1,2}$	min. 1.1 mm	Chamfer dimension

ABUTMENT DIMENSIONS

d_a	min. 76 mm	Diameter of shaft abutment
D_a	max. 104 mm	Diameter of housing abutment
D_b	min. 118 mm	Diameter of snap ring recess in the housing

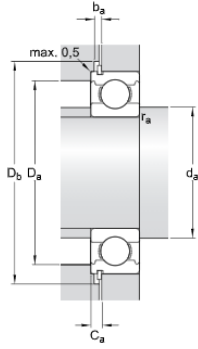

b_a	min. 3 mm	Width of snap ring recess in the housing
c_a	max. 5.33 mm	Distance from outer ring side face to snap ring back face
r_a	max. 1 mm	Radius of shaft or housing fillet

CALCULATION DATA

C	39.7 kN	Basic dynamic load rating
C_0	31 kN	Basic static load rating
P_u	1.32 kN	Fatigue load limit
	13 000 r/min	Reference speed
	8 000 r/min	Limiting speed
k_r	0.025	Minimum load factor
f_0	16	Calculation factor

MASS

	0.63 kg	Mass bearing
--	---------	--------------

INCLUDED PRODUCTS

SP 110	Snap ring
--------	-----------

TOLERANCE CLASS

P6	Dimensional tolerances
P6	Radial run-out